

INSTALL GUIDE – 399-610, 399-608

Replacing a drag or tangential head

Required tools

1. Small Phillips Screwdriver (Part # MT9004)
2. Leveling Tools (Part #'s 391-635 and 391-636)

Instructions:

Below is the description for the replacement of a standard drag head. The procedure described is also roughly applicable to the replacement of a tangential head. The areas where the replacement procedure for the tangential head differs are indicated between brackets and in italics.

The only major difference between replacing a drag knife and a tangential knife is the positioning of the screws on the carriage plate.

To remove the drag head, proceed as follows:

1. Take the knife holder out of the drag head.
2. Remove the front cover of the drag head by loosening the two [*three*] screws .
3. Loosen the flat cable by pulling the flat cable connector cover up. On both sides of the connector cover there is a small protuberance that you can pry up using a screwdriver. Gently pull the flat cable out of the connector
4. Remove the drag head. To do this, loosen the three screws with two counterclockwise rotations using a small diameter screw driver and lift the head upwards to remove it from the screws.

To re-install the drag head, proceed as follows:

1. Place the head back onto the screws. Tighten the screws with a 1 1/2 clockwise rotation. Do not tighten them firmly because the height and position of the head still need to be adjusted.
2. Put the knife holder into the drag head. [*Put the nose piece into the tangential head*].

Caution:
Make sure the tip of the knife does not protrude.

3. Secure the knife holder.

Note:
This only applies to the re-installation of a drag head.

4. Adjust the height and position of the head.

The standard operating procedure for doing this is described in the SummaSign Upgrade Kit (p/n 391-950). Note: The operating procedure described in the Upgrade Kit applies to a tangential head. However, the procedure to be followed for a drag head is roughly applicable.

Apart from the standard adjustment tools used in the standard operating procedure, you can use an ordinary 3½" disk to adjust the height and position of the head. To do this, proceed as follows:

- a. Put the disk against the drag head (the same way as you would put an adjustment plate against it) to verify that the drag head is positioned perpendicularly to the cutting surface.
- b. Slide the disk under the knife holder. If the disk touches the knife holder this means that the head is mounted too low. Readjust the mounting of the head.

5. Firmly tighten the screws once the drag head is properly positioned.
6. Put the flat cable back into the connector and close the connector. To ensure good contact, the flat cable must be positioned as deeply as possible and in the middle of the connector.
7. Remount the front cover of the head and firmly tighten the screws.
8. Proceed in the reverse order of removal. Make sure to firmly tighten all screws.

Note: Now that you have replaced the head, it is extremely important that you bring the data stored on the PCB in line with the head and vice versa. See Chapter 11, Configuration of the Head or the PCB for detailed information on how to do this.

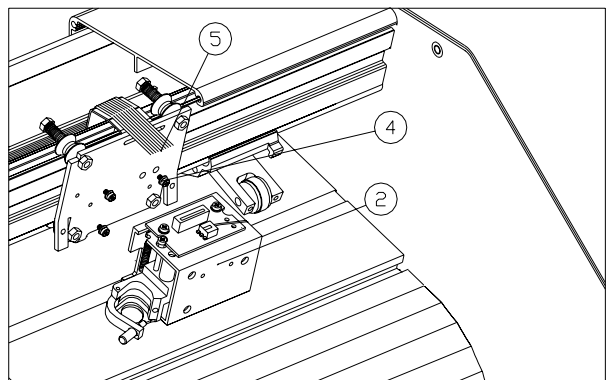
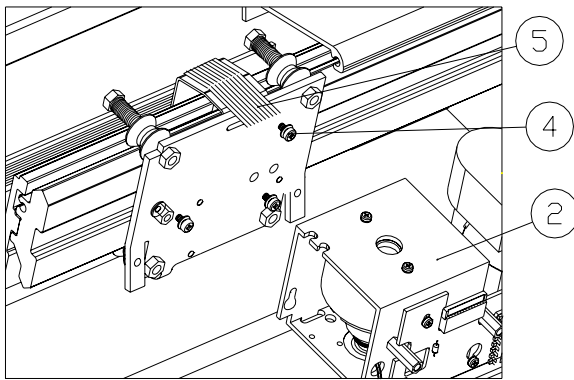
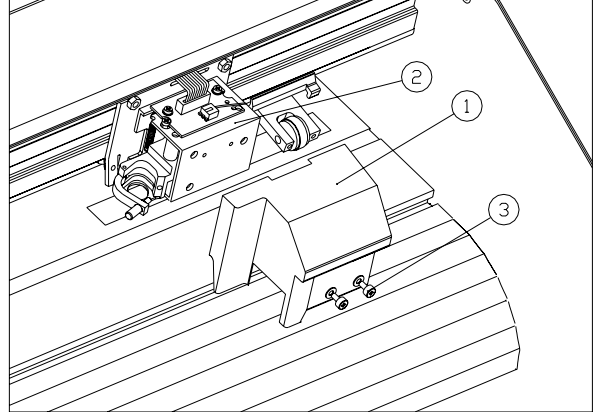
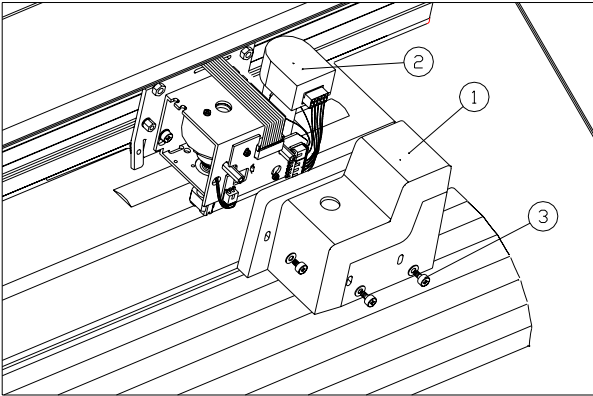

Tangential Head

Drag Head

- 1 head cover
- 2 head
- 3 screws cover head
- 4 position screws to hold head
- 5 flat cable